

A (x2)

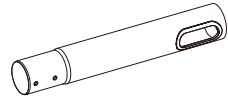

B (x2)

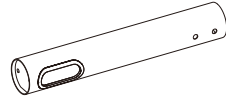

C (x2)



D (x2)



E (x2)



F (x4)



G (x8)



H (x4)  
D6



I (x8)



J (x4)  
M6x6



K (x4)  
M6x12



L (x4)  
M6x25



M (x1)  
4mm

1

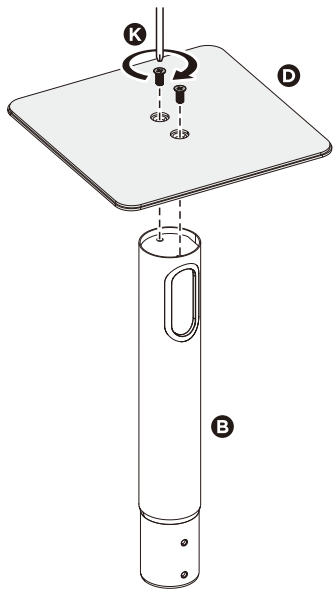

2

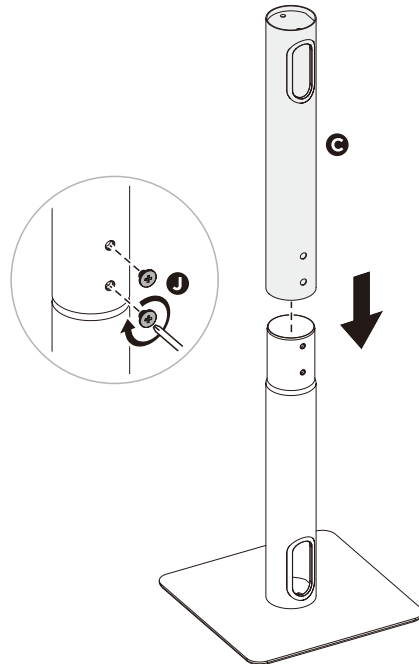

3

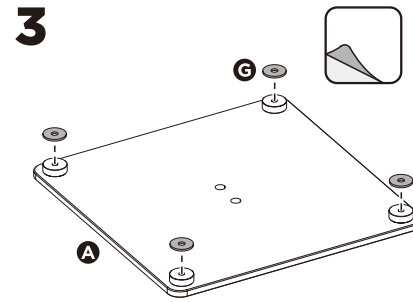

OR

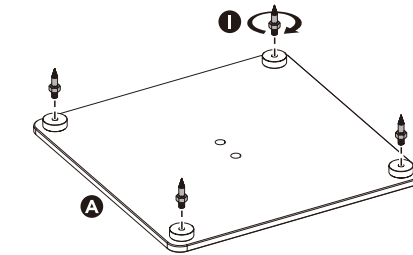

Note: Pointed nails for carpet surface.

4

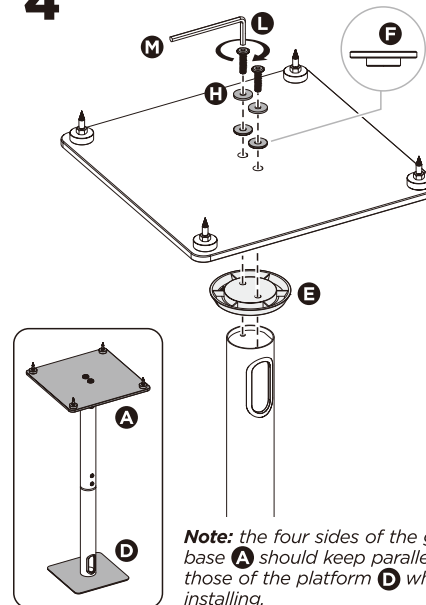

Note: the four sides of the glass base A should keep parallel to those of the platform D while installing.

5

